

CREATE
your STYLE™
with Swarovski®

FLOATING JEWELS FROM THE BEACH

INTERWEAVE YOUR INSPIRATION WITH THE POETRY OF NATURE



INSTRUCTION
GUIDE

OCEAN TREASURES



GLUING/BEADING

Components

- Beads** 
- Art. 5000 ø 3 mm
- Aquamarine
- Light Sapphire
- Light Azore ø 4 mm
- Light Sapphire ø 6 mm
- Light Azore ø 8 mm
- Aquamarine

- Beads** 
- Art. 5301 ø 6 mm
- Aquamarine
- Crystal

- Flat Backs** 
- Art. 2028
- Crystal AB, SS12

Material

- Seashell
- Crimp Bead

Beading & gluing instruction OCEAN TREASURES – PENDANT SEASHELL



STEP 1

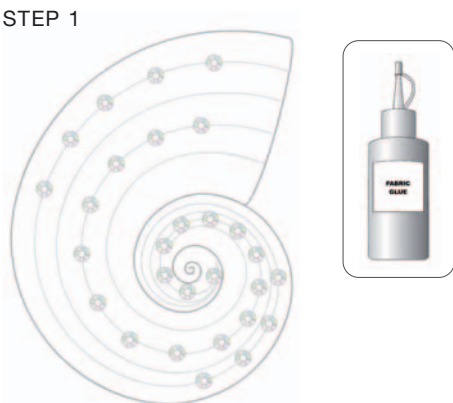

STEP 2



STEP 3



OCEAN TREASURES



Components

Beads
Art. 5000
ø 4 mm
Montana
ø 8 mm
Smoked Topaz

Beads
Art. 5301
ø 3 mm
Light Smoked Topaz

Fancy Stones
Art. 6721
ø 28 mm
Crystal

Material

Seashell

Crimp Bead

Beading instruction OCEAN TREASURES – PENDANT CRYSTAL STAR



STEP 1



STEP 2



OCEAN TREASURES



Components

Beads
Art. 5000
ø 4 mm
Erenite AB
ø 6 mm
Light Sapphire
ø 8 mm
Black Diamond



Beads
Art. 5301
ø 4 mm
Erenite
ø 5 mm
Montana AB



Fancy Stones
Art. 6723
ø 28 mm
Crystal



Material

Seashell

Crimp Bead

Beading instruction OCEAN TREASURES – PENDANT CRYSTAL SHELL



STEP 1



STEP 2



OCEAN TREASURES

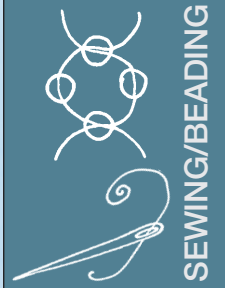

Components

Beads
Art. 5000
ø 4 mm
Blue Zircon
Aquamarine
ø 6 mm
Blue Zircon
Pacific Opal



Beads
Art. 5301
ø 4 mm
Indicolite



Material

Shells

Crimp Bead

Beading & sewing instruction OCEAN TREASURES – PENDANT TWO SHELLS



STEP 1

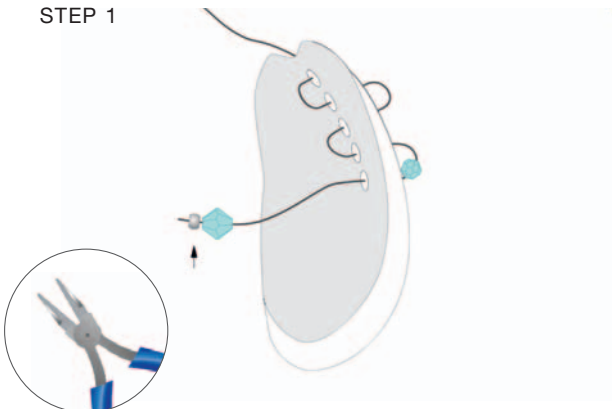

STEP 2

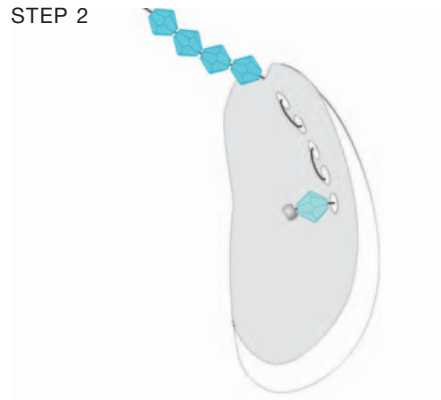

STEP 3



OCEAN TREASURES



Components

Beads
Art. 5000
ø 4 mm
Golden Shadow
Metallic Blue



Material

Seashell

Pebble

Sewing instruction OCEAN TREASURES – PENDANT PEBBLE



STEP 1



STEP 2

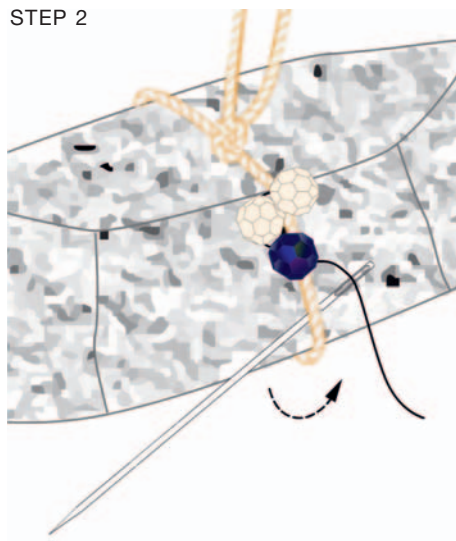

OCEAN TREASURES

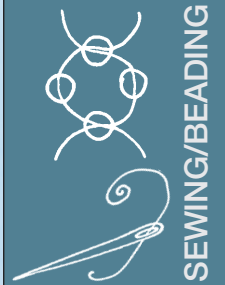

SEWING/BEADING

Components

- Beads**
 Art. 5000
 ø 4 mm
 Metallic Blue
 Golden Shadow
 ø 6 mm
 Smoked Topaz
 Light Sapphire AB
 Black Diamond
 ø 8 mm
 Black Diamond
- Pendants**
 Art. 6010
 ø 11 mm
 Golden Shadow

Material

- Cork
 Crimp Beads

Beading & sewing instruction OCEAN TREASURES – PENDANT CORK



STEP 2



STEP 1

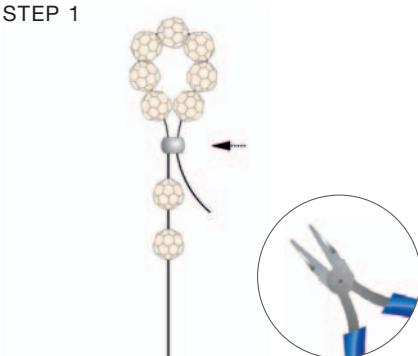

STEP 3

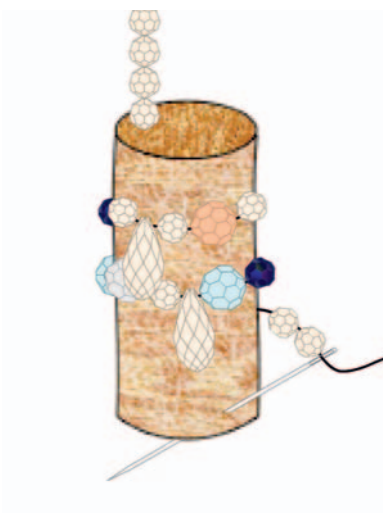

STEP 4

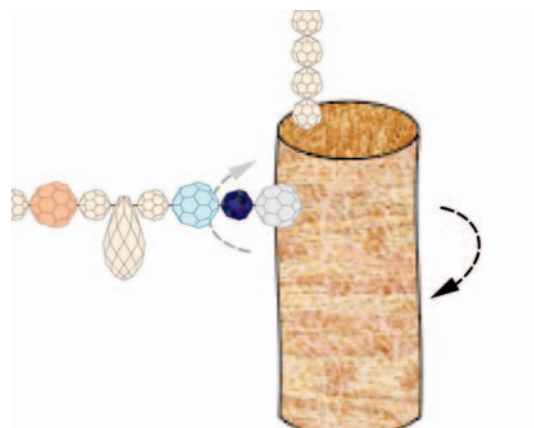

OCEAN TREASURES



Components

1
Sew-On Stones
Art. 3002
ø 14 mm
Crystal



2
Beads
Art. 5000
ø 4 mm
Light Sapphire



Material

1
Lobster claw
Textile strip

2
Button (Bone)
Crimp Bead

1 Sewing instruction OCEAN TREASURES – CRYSTAL BUTTON



STEP 1

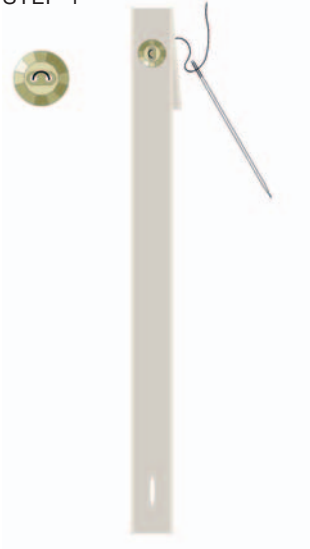

STEP 2



2 Sewing instruction OCEAN TREASURES – CRYSTAL KNOT



STEP 1



OCEAN TREASURES

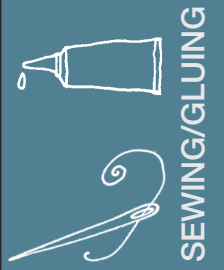

Components

Sew-On Stones
Art. 3014
ø 14 mm
Volcano
Tabac

Sew-On Stones
Art. 3015
ø 14 mm
Meridian Blue M

Sew-On Stones
Art. 3016
ø 14 mm
Dorado
Metallic Blue

Material

Brooch

Cord, 2 m

Sewing & gluing instruction OCEAN TREASURES – BROOCH



STEP 1

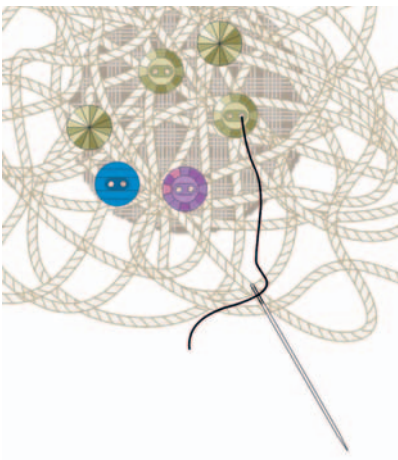

STEP 3

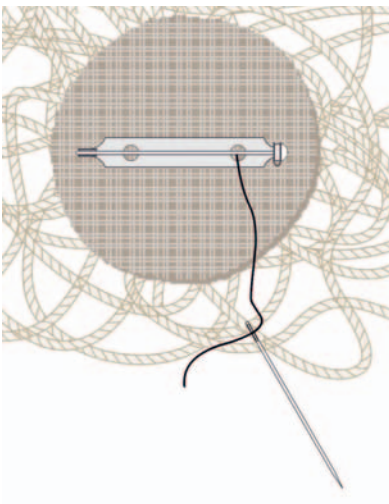

STEP 2

